

SHARED USE PATH			
STATION AND OFFSET	AREA	REMARKS	
11+77, 23' RT TO 12+37, 23' RT	72.53 SY	PATH BETWEEN ENTRANCE AND EXIT	
12+81, 23' RT TO 15+58, 46' RT	310.7 SY	PATH BETWEEN BUS EXIT AND CLARKSBURG RD	

MDOT SHA TYPE A COMBINATION CURB AND GUTTER (MD-620.02)			
STATION AND OFFSET	LENGTH	REMARKS	
11+79, 17' RT TO 12+35, 17' RT	58'	BARNESVILLE RD	
12+83, 17' RT TO 15+73, 53' RT	301'	BARNESVILLE RD	

MDOT SHA TYPE D CURB (30 INCH) (MD-620.02-01)			
STATION AND OFFSET	LENGTH	REMARKS	
12+34, 86' RT TO 12+79, 131' RT	100'	SIDEWALK	

SOIL BORING REQUEST			
BORING	NORTHING	EASTING	ELEV
PB-01	552,990	1,223,273	428.74'
PB-02	552,954	1,223,428	427.43'
PB-03	552,946	1,223,278	428.83'
PB-04	552,876	1,223,397	430.05'
ES-01	552,969	1,223,301	429.22'
ES-02	552,936	1,223,412	431.46'
SWM-01	552,968	1,223,334	428.81'
SWM-02	552,918	1,223,455	430.93'
SWM-03	552,924	1,223,226	426.37'
SWM-04	552,881	1,223,553	418.66'
SWM-05	552,809	1,223,606	419.33'
MW-BCS	553,003	1,223,288	429.48'

MCDOT TYPE A COMBINATION CURB AND GUTTER (MC-100.01)			
STATION AND OFFSET	LENGTH	REMARKS	
11+42, 46' RT TO 12+83, 18' RT	953'	BOYDS COUNTRY STORE TO BUS EXIT	
11+79, 17' RT TO 12+35, 17' RT	165'	PARK AND RIDE BUS LOOP	
13+07, 87' RT TO 14+93, 86' RT	495'	PARKING LOT	

REMOVAL OF EXISTING RIPRAP	
STATION AND OFFSET	SY
STA 15+55, 55' RT	18

5 INCH SIDEWALK			
STATION AND OFFSET	AREA	REMARKS	
11+10, 44' RT TO 12+97, 129' RT	3310.6 SF	SIDEWALK FROM COUNTRY STORE TO PARKING LOT	
11+65, 33' RT TO 11+77, 23' RT	124 SF	SHARED USE PATH RAMP	
12+37, 23' RT TO 12+48, 31' RT	124 SF	SHARED USE PATH RAMP	
12+70, 31' RT TO 12+81, 23' RT	124 SF	SHARED USE PATH RAMP	
15+52, 54' RT TO 15+72, 53' RT	195 SF	SHARED USE PATH RAMP	
11+72, 111' RT TO 12+11, 157' RT	861.9 SF	RAMP TO MARC STATION	

CURB HEIGHT TRANSITION  
 0" TO 30":  
 STA. 12+34, 86' RT TO STA. 12+55, 86' RT  
 30" TO 0":  
 STA. 12+81, 107' RT TO STA. 12+79, 131' RT

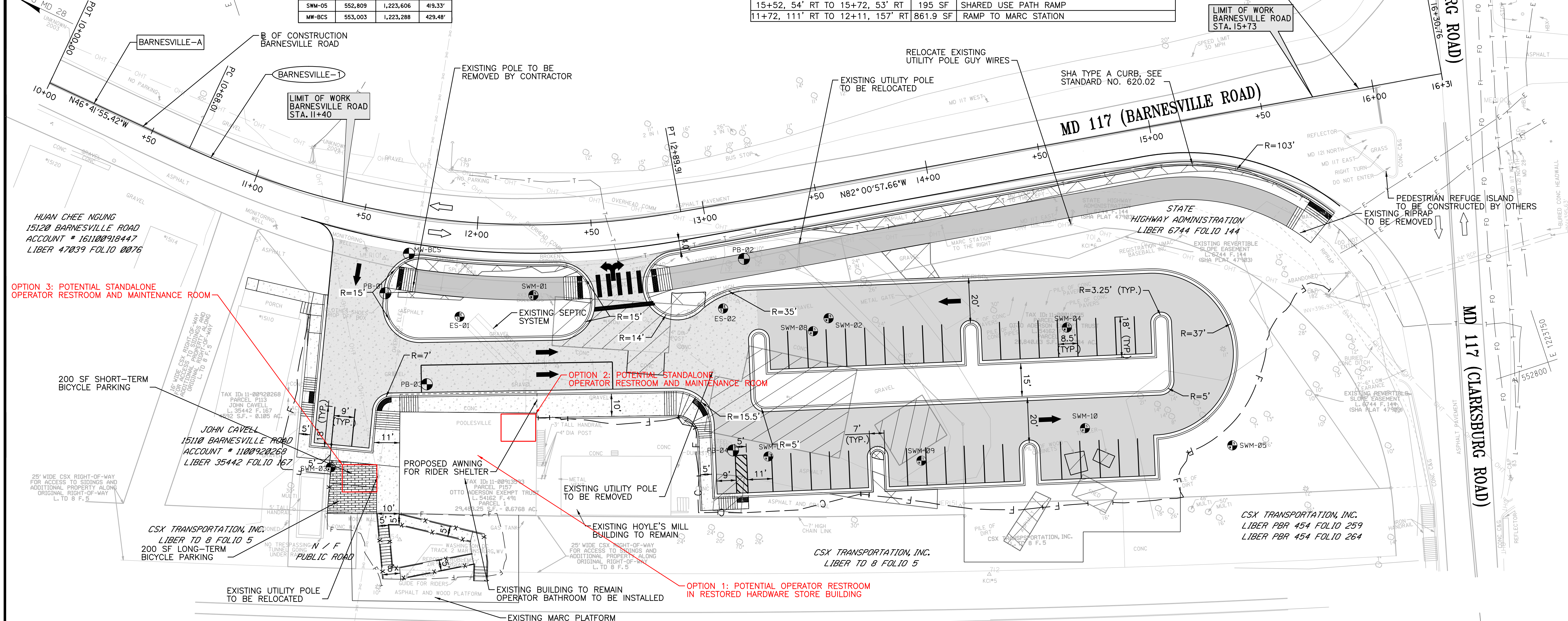

OPTION 3: POTENTIAL STANDALONE OPERATOR RESTROOM AND MAINTENANCE ROOM

OPTION 2: POTENTIAL STANDALONE OPERATOR RESTROOM AND MAINTENANCE ROOM

OPTION 1: POTENTIAL OPERATOR RESTROOM IN RESTORED HARDWARE STORE BUILDING

LEGEND	
	FULL DEPTH ASPHALT PAVEMENT
	FULL DEPTH PERVIOUS CONCRETE PAVEMENT
	FULL DEPTH CONCRETE PAVEMENT
	CONCRETE SIDEWALK
	DETECTABLE WARNING SURFACE
	BRICK
	PAVEMENT REMOVAL
	BUILDING REMOVAL/RELOCATION/SALVAGE (UNDER SEPERATE CONTRACT)

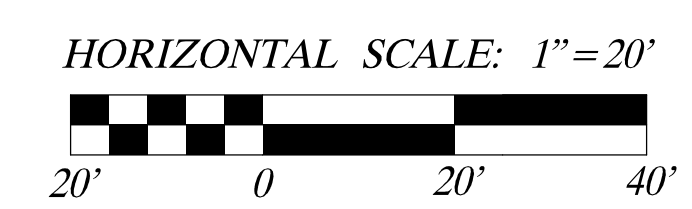

CURVE DATA									
CURVE	DELTA	Dc	R	L	T	E	PI NORTH	PI EAST	
BARNESVILLE-1	35°19' 02.24"	LT	15°54' 55.78"	360.00'	221.91'	114.60'	17.80'	552,998.74	1,223,294.21

LINE DATA		
LINE	LENGTH	BEARING
BARNESVILLE-A	68.00'	N 46° 41' 55.42" W
BARNESVILLE-B	340.85'	N 82° 00' 57.66" W

PROFESSIONAL CERTIFICATION.  
 I HEREBY CERTIFY THAT THESE DOCUMENTS WERE PREPARED OR APPROVED BY ME, AND THAT I AM A DULY LICENSED PROFESSIONAL ENGINEER UNDER THE LAWS OF THE STATE OF MARYLAND, LICENSE NO. \_\_\_\_\_ EXPIRATION DATE: \_\_\_\_\_

**Whitman, Requardt & Associates, LLP**  
 801 South Caroline Street, Baltimore, Maryland 21231

NO.	REVISION	DATE	BY

MONTGOMERY COUNTY  
 DEPARTMENT OF TRANSPORTATION  
 GAITHERSBURG, MARYLAND

RECOMMENDED FOR APPROVAL

Chief, Transportation Planning and Design Section \_\_\_\_\_ Date \_\_\_\_\_

Chief, Division of Transportation Engineering \_\_\_\_\_ Date \_\_\_\_\_

Designed by: PHD Drawn by: AMU Checked by: JAG

HD-01 ROADWAY PLAN

BOYDS TRANSIT IMPROVEMENTS

SCALE: 1" = 20'

SEPTEMBER 2020

Project No.: 32207.003 SHEET 8 of 2

N:\32207-003\CADD\410-0001\_Boysds.dgn  
 1/17/2022